

FELPRO PERFORMANCE GASKETS

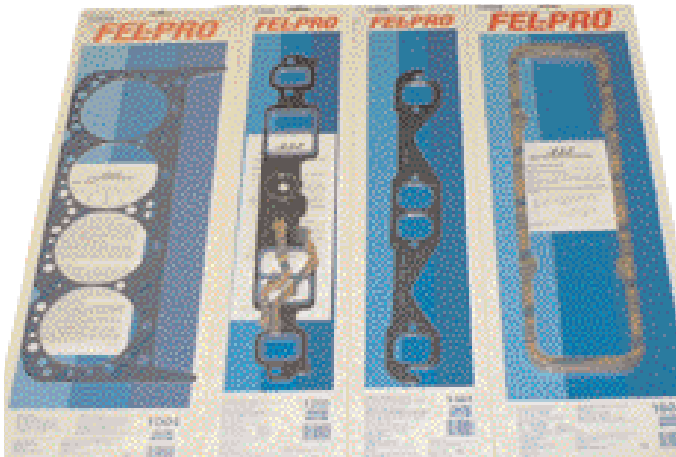

GOODRIDGE RACING HOSE



SIZE	ID	OD	OPER PRESS	PART #
#4	.22	.44	1000PSI I	200-04
#6	.34	.55	1000PSI	200-06
#8	.44	.65	1000PSI	200-08
#10	.56	.80	1000PSI	200-10
#12	.69	.94	1000PSI	200-12
#16	.88	1.15	750PSI	200-16
#20	1.13	1.41	500PSI	200-20

ALUM REUSABLE FITTINGS

HEAD GASKET W/STEEL RING (350) (SBC)	1003
HEAD GASKET W/STEEL RING (400) SBC	1004
HEAD GASKET W/COPPER RING SBC	1010
HEAD GASKET W/STEEL RING SBC	1034
HEAD GASKET	1094
INTAKE GASKET SET STOCK SBC	1204
INTAKE GASKET SET STOCK PRINTO SBC	1205
INTAKE GASKET SET RACE PRINTO SBC	1206
INTAKE GASKET SET LARGE RACE PRINTO SBC	1207
EXHAUST GASKET SET STOCK SBC	1404
EXHAUST GASKET SET LARGE SBC	1405
EXHAUST GASKET SET D PORT SBC	1406
EXHAUST GASKET SET SPREAD PORT SBC	1409
VALVE COVER GASKET SET CORK SBC	1603
VALVE COVER GASKET SET STEEL CORE CORK	1604
VALVE COVER GASKET RUBBER SBC	1628
VALVE COVER GASKET RUBBER, BBC	1635
VALVE COVER GASKET, RED PLASTIC, SBC	VS18269T
OIL PAN GASKET SET 1957-74 (THIN) SBC	1802
OIL PAN GASKET SET 1975-79 (THICK), SBC	1803
OIL PAN GASKET SEAT STEEL CORE SBC	1821
CARB BASE GASKET OPEN HOLLEY	1900
CARB BASE GASKET 2BBL HOLLEY	1904
R.A.C.E.. SEAT SBC	2702
REAR MAIN SEAL SBC	2900
SCE COPPER EXHAUST GASKET SBC SQ PORT	4211
SCE COPPER EXHAUST GASKET SBC RD PORT	4011
SCE COPPER EXHAUST GASKET SBC BRODIX	4411
SCE 2 BARREL CARB GASKET 10 PACK	349
SCE 4 BARREL CARB GASKET OPEN 10 PACK	354
SCE 4 BARREL CARB GASKET 4 HOLE 10 PACK	355

Aeroquip's revolutionary one-piece fitting design offers motorsport enthusiasts uncompromised quality and assurance that they are using the highest performing components available. These compression-style fittings are easier to assemble and swivel, and they offer significantly better seal integrity than out-dated cutter-style fittings. They are available in swivel and non-swivel styles, as well as in red and blue anodized and nickel-plated finishes. The fittings are designed for use with AQP stainless steel racing hose and Aeroquip's StartLite hose.

STRAIGHT
T SAE
SWIVEL

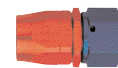

#4	FCM1011
#6	FCM1012
#8	FCM1013
#10	FCM1014
#12	FCM1015
#16	FCM1016

45°
ELBOW
SAE
SWIVEL

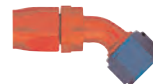

#4	FCM1021
#6	FCM4022
#8	FCM4023
#10	FCM4024
#12	FCM4025
#16	FCM4026

90°
ELBOW
SAE
SWIVEL

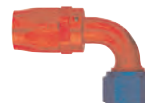

#4	FCM1031
#6	FCM4032
#8	FCM4033
#10	FCM4034
#12	FCM4035
#16	FCM4036

120°
ELBOW
SAE
SWIVEL



#6	FCM4052
#8	FCM4053
#10	FCM4054
#12	FCM4055

180°
ELBOW
SAE
SWIVEL



#6	FCM4062
#8	FCM4063
#10	FCM4064
#12	FCM4065

1-800-328-3618

LOU FEGERS RACING EQUIPMENT

AEROQUIP ALUMINUM PIPE ADAPTERS

MALE CONNECTOR



#4 TO 1/8" P	FCM2001
#4 TO 1/4" P	FCM2002
#6 TO 1/8" P	FCM2003
#6 TO 1/4" P	FCM2004
#6 TO 3/8" P	FCM2005
#8 TO 1/4" P	FCM2006
#8 TO 3/8" P	FCM2007
#8 TO 1/2" P	FCM2008
#10 TO 3/8" P	FCM2185
#10 TO 1/2" P	FCM2009
#12 TO 1/2" P	FCM2010
#12 TO 3/4" P	FCM2011
#16 TO 1" P	FCM2012

45° MALE ELBOW



#4 TO 1/8" P	FCM2021
#6 TO 1/4" P	FCM2022
#8 TO 3/8" P	FCM2023
#10 TO 1/2" P	FCM2024
#12 TO 3/4" P	FCM2025
#16 TO 1" P	FCM2026

90° MALE ELBOW



#4 TO 1/8" P	FCM2031
#4 TO 1/4" P	FCM2032
#6 TO 1/8" P	FCM2033
#6 TO 1/4" P	FCM2034
#6 TO 3/8" P	FCM2035
#8 TO 1/4" P	FCM2036
#8 TO 3/8" P	FCM2037
#8 TO 1/2" P	FCM2038
#10 TO 1/2" P	FCM2039
#12 TO 3/4" P	FCM2040
#16 TO 1" P	FCM2041

MALE BRANCH TEE



#4 TO 1/8" P	FCM2121
#6 TO 1/4" P	FCM2122
#8 TO 3/8" P	FCM2123

MALE RUN TEE



#4 TO 1/8" P	FCM2124
#6 TO 1/4" P	FCM2125
#8 TO 3/8" P	FCM2126

AEROQUIP ALUMINUM FLARE ADAPTERS

FLARE UNION



#4	FCM2051
#6	FCM2052
#8	FCM2053
#10	FCM2054
#12	FCM2055
#16	FCM2056



#4	FCM2119
#6	FCM2120
#8	FCM2190
#12	FCM2191

90° ELBOW UNION

UNION REDUCER



#4 TO #3	FCM2048
#6 TO #4	FCM2156
#8 TO #4	FCM2049
#8 TO #6	FCM2160
#10 TO #6	FCM2162
#10 TO #8	FCM2163
#12 TO #8	FCM2166
#12 TO #10	FCM2167
#8F TO #6M	FCM2410 (STEEL)



UNION TEE

#4	FCM2061
#6	FCM2062
#8	FCM2063
#10	FCM2064
#12	FCM2065
#16	FCM2066



FEMALE FLARE SWIVEL

#4	FCM2914
#6	FCM2915
#8	FCM2916
#10	FCM2917
#12	FCM2918



FEMALE FLARE TEE

#4	FCM2173
#6	FCM2174
#8	FCM2175
#10	FCM2176
#12	FCM2177

ALUMINUM AN BULKHEAD ADAPTERS

BULKHEAD UNION



#4	FCM2071
#6	FCM2072
#8	FCM2073
#10	FCM2074
#12	FCM2075
#16	FCM2076



90° ELBOW BULK-HEAD UNION

#4	FCM2081
#6	FCM2082
#8	FCM2083
#10	FCM2084
#12	FCM2085
#16	FCM2086



BULKHEAD TEE

#4	FCM2091
#6	FCM2092
#8	FCM2093
#10	87044
#12	87045



45° ELBOW BULK-HEAD UNION

#4	FCM2127
#6	FCM2128



BULKHEAD RUN TEE

#4	FCM2117
#6	FCM2118
#8	FCM2180

1-800-328-3618

LOU FEGERS RACING EQUIPMENT

AEROQUIP STARTLITE HOSE



Manufactured by Aeroquip to provide you with a superior performing lightweight racing hose. Utilizing the latest technology, our Nomex fire-retardant covered hose provides up to a 45% weight savings compared with traditional stainless steel racing hose assemblies. The patented AQP inner tube offers a 300° temperature rating and unsurpassed fluid compatibility. Use with either our lightweight crimp fittings, or our aluminum reusable fittings. Applications include fuel, lube, coolant, and air.

#6	FBU0600
#8	FBU0800
#10	FBU1000
#12	FBU1200
#16	FBU1600
#20	FBU2000

GOODRIDGE SOCKETLESS HOSE



#6	536-06
#8	536-08
#10	536-10
#12	536-12

AEROQUIP STARTLITE FITTINGS

	STRAIGHT	45 DEG	90 DEG
#6	FBM4212	FBM4222	FBM4232
#8	FBM4213	FBM4223	FBM4233
#10	FBM4214	FBM4224	FBM4234
#12	FBM4215	FBM4225	FBM4235
#16	FBM4216	FBM4226	FBM4236

POWER STEERING HOSE AND FITTINGS

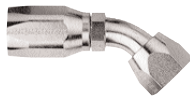
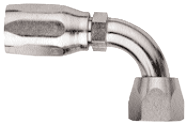

#6	185-9006P
#10	185-9010P

#6	185-4506P
#10	185-4510P

#6	185-0106P
#10	185-0110P

#6 POWER STEERING HOSE	185-06
#10 POWER STEERING HOSE	185-10

ALUM SOCKETLESS FITTINGS

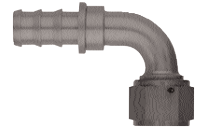

#4	536-0104
#6	536-0106
#8	536-0108
#10	536-0110
#12	536-0112

#4	536-4504
#6	536-4506
#8	536-4508
#10	536-4510
#12	536-4512

#4	536-9004
#6	536-9006
#8	536-9008
#10	536-9010
#12	536-9012

GM POWER STEERING FITTINGS

'82 & UP BOX

UP TO '81

LATE GM
PS PUMP

LATE GM
PS PUMP



W/O-RING



SMALL	185005
LARGE	185006

SMALL	185002
LARGE	185003

OUTLET	37130
--------	-------

RETURN	37131
--------	-------

1-800-328-3618

DUST CAPS AND PLUGS



SIZE	PKG	DUST CAP	DUST PLUG
#3	20	FBM3647	FBM3654
#4	20	FBM3648	FBM3655
#6	20	FBM3649	FBM3656
#8	20	FBM3650	FBM3657
#10	12	FBM3651	FBM3658
#12	10	FBM3652	FBM3659
#16	10	FBM3653	FBM3660
ASSORTMENT OF 20		50820	50830

KEVKO OIL PANS AND PICKUPS

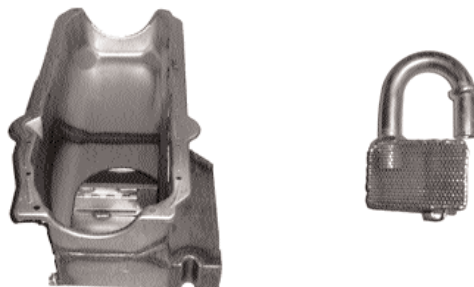

AN CAPS



SIZE	PKG	PART#
#4	2	FCM3752
#6	1	FCM3740
#8	1	FCM3741
#10	1	FCM3742
#12	1	FCM3743

PIPE AND AN PLUGS

ALLEN HEAD PIPE PLUGS	
1/8"	FCM3685
1/4"	FCM3686
3/8"	37812
1/2"	37810
3/4"	FCM3750

AN PLUGS	
#4	FCM3713
#6	FCM3714
#8	FCM3715
#10	FCM3716
#12	FCM3717
#16	FCM3718

PART #	DESCRIPTION	PICKUP #
1086L	7 QT CAPACITY, 7 1/4" DEEP, CLAIMER OIL PAN, LEFT HAND DIPSTICK	1001 STD 1002 HI VOL
1086R	7 QT CAPACITY, 7 1/4" DEEP, CLAIMER OIL PAN, RIGHT HAND DIPSTICK	1001 STD 1002 HI VOL
1087	7 QT CAPACITY STOCK STYLE CORE METRIC CAR W/ENGINE LOWERED	1003
1089	8 QT CAPACITY, METRIC CAR W/ENGINE LOWERED	1007 STD 1008 HI VOL 1012 BIG BLOCK
1090	8 QT CAPACITY	1005 HI VOL 1003 STD 1010 BIG BLOCK

CHAMP PANS AND PICKUPS



ALUMINUM LOCK NUTS



#4	FCM2099
#6	FCM2100
#8	FCM2103
#10	FCM2104
#12	FCM2105
#16	FCM2106

O-RINGS

#4	FCM3473
#6	FCM3474
#8	FCM3475
#10	FCM3476
#12	FCM3477

•10 PER PACK
•NITRILE ORINGS



PANS	
CP55	8" CLAIMER PAN, STOCK FRONT STUB
CP57	7" CLAIMER PAN
CP100	LATE MODEL PAN
CP100LT	WET SUMP OIL PAN
PICKUPS	
55SB	PICKUP 8" PAN, SBC
57SB	PICKUP 7" PAN, SBC
80SB	PICKUP 8" PAN, SBC
100SB	PICKUP 7" PAN, SBC
100BB	PICK UP 7" PAN, BBC

1-800-328-3618